



# Foundations

- Conduct a self-assessment
  - The Carnegie Foundation for the Advancement of Teaching
  - Self-Assessment Rubric for the Institutionalization of Service-Learning in Higher Education by Andrew Furco
  - CAS Service-Learning Programs Self-Assessment Guide

# Identify Allies

- Key Administrators
- Influential Faculty
- Strong Colleagues
- Strategic Community Partners
- Student Leadership
- Models and Mentors

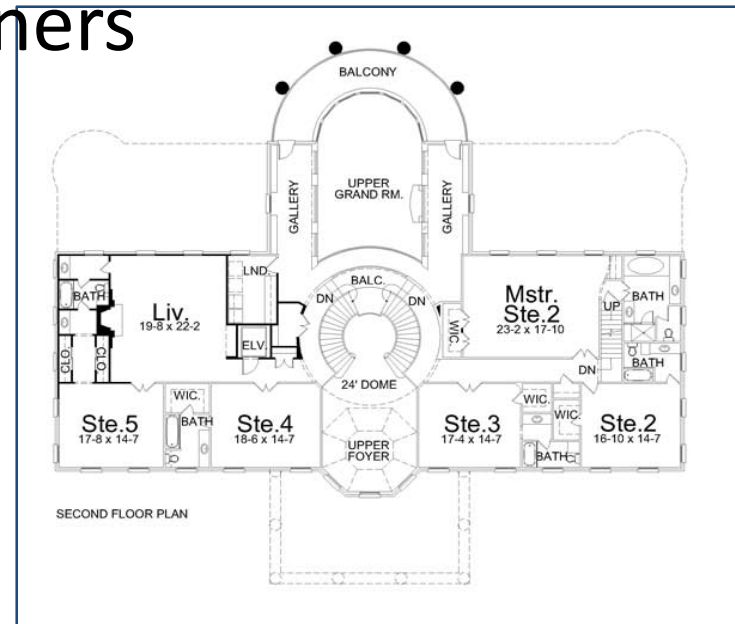

# Build the Scaffolding



## **MISSION STATEMENT**

The Kernodle Center for Service Learning at Elon University, in partnership with local and global communities, advances student learning, leadership, and citizenship to prepare students for lives of active community engagement within a complex and changing world.

# Values

This preparation is grounded in an ethic of service that appreciates multiple perspectives, creates opportunities that are affirming and empowering to all, and responds to the needs of our diverse communities.

To fulfill our mission, the Kernodle Center for Service Learning:

- Educates students through curricular and co-curricular experiences encompassing direct service, indirect service and advocacy
- Creates and supports collaborative and sustainable relationships between faculty, staff, students and community partners
- Encourages personal responsibility and a deeper understanding of societal issues
- Fosters creative solutions to social concerns and identified community needs, and
- Builds student leadership, community capacity and faculty and staff engagement.

# Vision

- Begin creating your strategic plan for the next three years
- Build on strengths
- Look for an early success
- Identify resources
- Include allies in the process

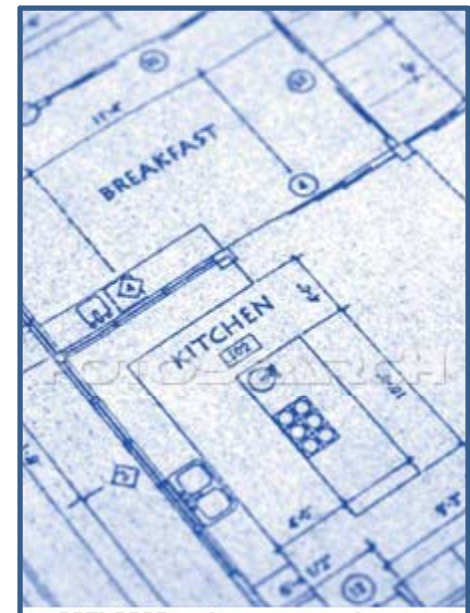

# Bricks and Mortar

- Faculty Development Programs
  - Faculty Scholars
  - Orientation and Training
  - Research Groups
- Student-Led Programs
  - Events  
(Make a Difference Day, Blood Drives)
  - On-going Programs  
(Tutoring, Green Team )
  - Learning Community



# Finishing Touches

- Public Relations
- Awards and Recognition
- Annual Reports
- Assessment and Evaluation
- Presentations and Publications

